

CUSTOM-BILT METALS

Brand Products

PBR & TFR-36 Installation Guide



All information, descriptions and dimensions in this manual are current at the time of printing. As always, Custom-Bilt Metals in an effort to improve our product line reserves the right to make changes with products, details or designs, as necessary without notice and incurring no obligation. Please contact your local Custom-Bilt Metals Sales Representative for the most current information or visit our website at www.custombiltmetals.com

Table of Contents

SECTION	PAGE
Designer Notes	1
Panel Profile / Net Coverage	2
Accessories / Fasteners	3
ROOF Details	
Eave	4
Ridge	5
Hip	6
Rake	7
Sidewall	8
Headwall	9
Valley	10
Panel End Lap	11
Wall Details - Horizontal / Vertical	
Base / Drip	12
Inside Corner – Corrugated to Corrugated	13
Inside Corner – Corrugated to Other	14
Outside Corner	15
Door / Window Head	16
Door / Window Jamb	17
Window Sill	18
Pipe Flashing	19

Designer/Installer Notes

PBR & TFR-36

GENERAL

Custom-Bilt Metals (herein as CBM) is providing the following installation instructions and details as a guideline, and are CBM's recommended procedures. All local building codes and project specifications should be followed, however, in all cases, good roofing practices, and good workmanship should be employed when constructing a roofing system using CBM's products. These procedures and details are not intended to cover all instances, building requirements, designs, or codes. These details may require changes or revisions for each project, as conditions vary from project to project. The details provided are proven methods of construction. Work shall be performed by experienced craftsmen familiar with metal roofing products and current industry standards. Joint designs and high quality sealants, gaskets and tapes are available and are recommended for prefinished metals.

METAL ROOF SYSTEM

CBM's roof systems are Zinalume, G-90 galvanized steel, copper and aluminum. Various gauges are available. The steel and aluminum panels are available prefinished with Silicon Modified Polyester (SMP) or a Kynar 500 / Hylar 5000 paint system. Bare Zinalume (Zinalume Plus) is also available. All flashing and trim, unless requested otherwise, are of the same gauge and finish as the roof panels. Refer to your project specifications for actual requirements. Contact a CBM sales representative for details.

SEALANTS

Sealants not exposed to direct sunlight should consist of either an elastic butyl rubber tape or a non-skinning, non-drying gun-able butyl. Single part polyurethane's should be used when exposed to ultraviolet light. All sealants should be applied to clean, dry surfaces to ensure weather tightness. Sealants shall be installed as shown without voids.

SUBSTRATE

The PBR and TFR-36 profiles may be installed on solid substrate and or open framing systems. The distance the panel can span and the fasteners used will vary depending on design criteria of any given building. The substrate must be on an even plane to avoid panel distortion. The plane of the substrate should not vary more than 1/4" in 20 feet. Some design issues to consider are live load, snow load, wind design, etc. Contact a CBM sales representative for details.

UNDERLAYMENT

For roof applications over a solid substrate, CBM recommends a minimum of Type 30 Felt or synthetic underlayment. The underlayment used may depend on specific project conditions. For wall applications the use of a high quality vapor barrier may be required.

DELIVERY & STORAGE

Handle panels and bundles with care. Crated panels shall be lifted at blocked locations. Do not use ropes or wire cables for lifting. Long panels (25 ft. or more) may require two or more lift points to avoid bending or buckling of panels. Store panels in a dry, well ventilated area. Elevate one end of panels to allow for drainage of any moisture. Block panels off the ground. Do not store panels in direct contact with the ground.



TFR-36

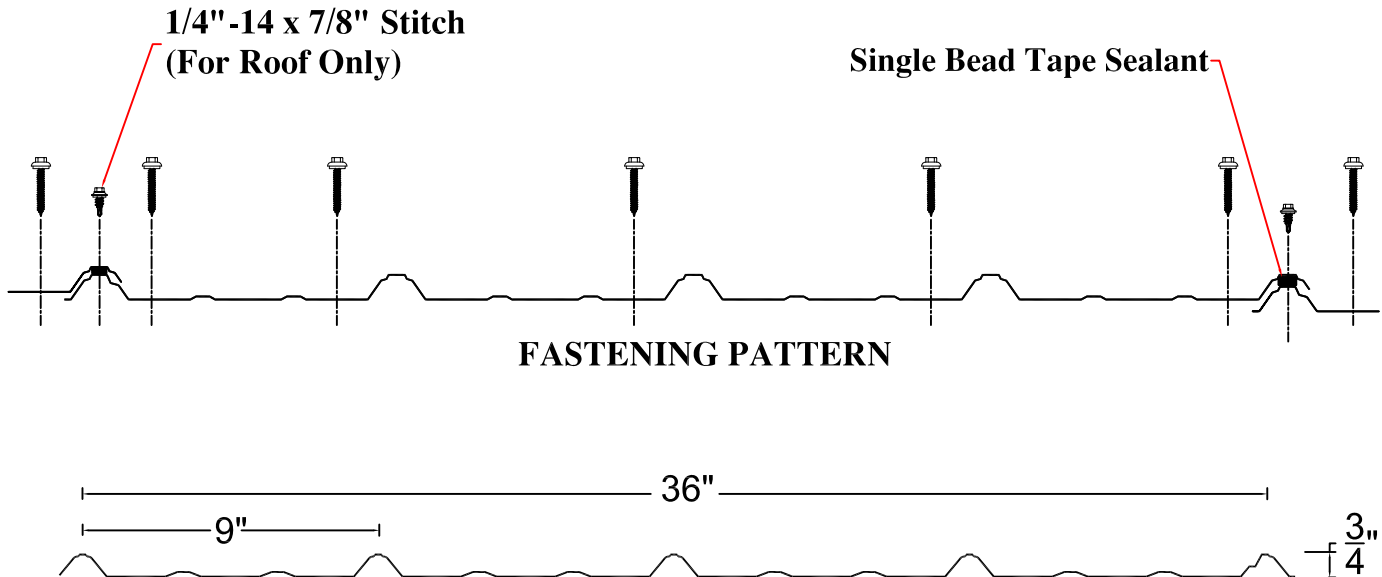

PBR

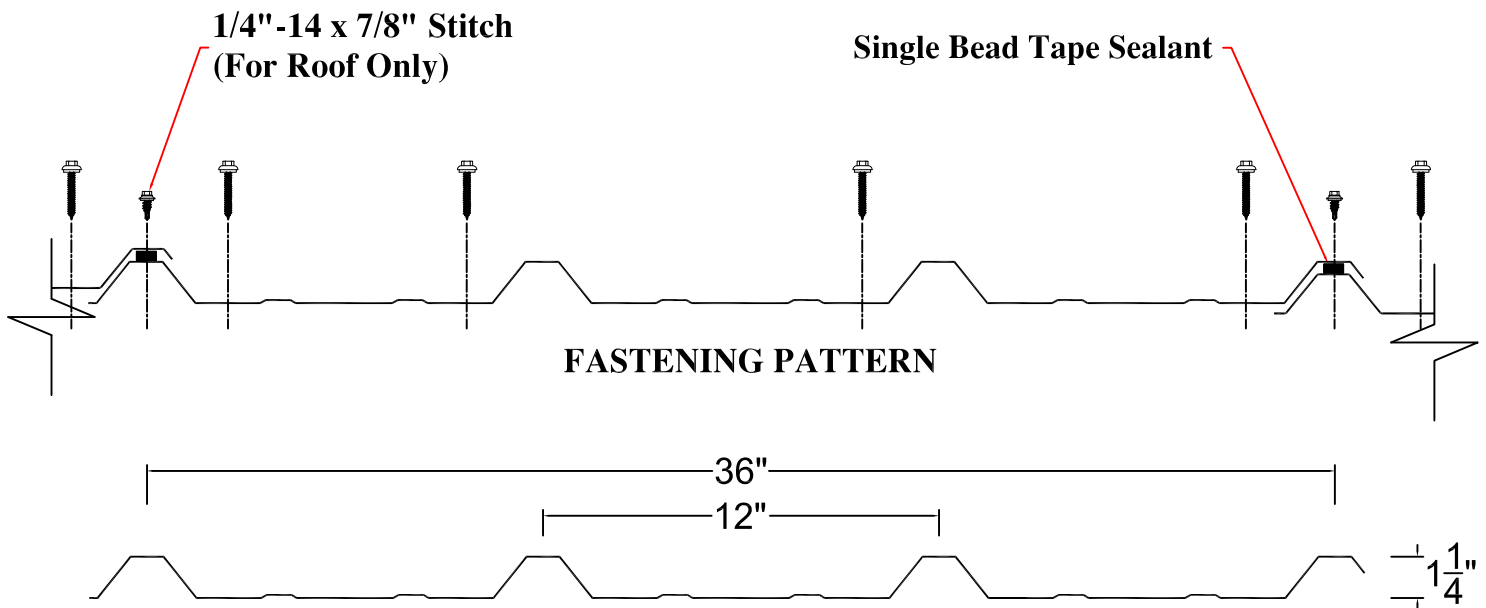

All Flashing and Trim available through CBM

SUBJECT TO CHANGE WITHOUT NOTICE

Note:



ACCESSORIES

AG-5 RIB TOP CLOSURE







AG-5 RIB BOTTOM CLOSURE

PBR TOP CLOSURE



PBR BOTTOM CLOSURE

	#9x1", 1 1/2", 2", 2 1/2", 3" WOOD SCREW 1/4" HEX HEAD	PANEL TO DIMENSIONAL LUMBER.
	#14x1", 1 1/2", 2", 2 1/2" WOOD SCREW 5/16" HEX HEAD	PANEL TO PLYWOOD MIN. 1/2" THICK, STRUCTURAL GRADE
	#14x7/8" LAP SELF DRILLER 5/16" HEX HEAD	TRIM AND SIDE LAP ATTACHMENTS
	STST-43 STAINLESS STEEL RIVET 1/8 x 1/8	TRIM TO TRIM OR TRIM TO PANEL ATTACHMENTS
	#12x1", 1 1/2", 2", 2 1/2" SELF DRILLER 5/16" HEX HEAD	PANEL TO PURLIN OR DECK ATTACHMENTS

All Flashing and Trim available through CBM	Note:
SUBJECT TO CHANGE WITHOUT NOTICE	

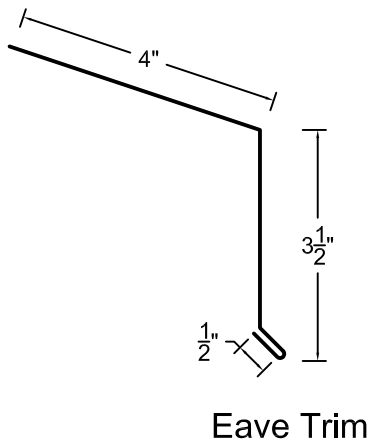
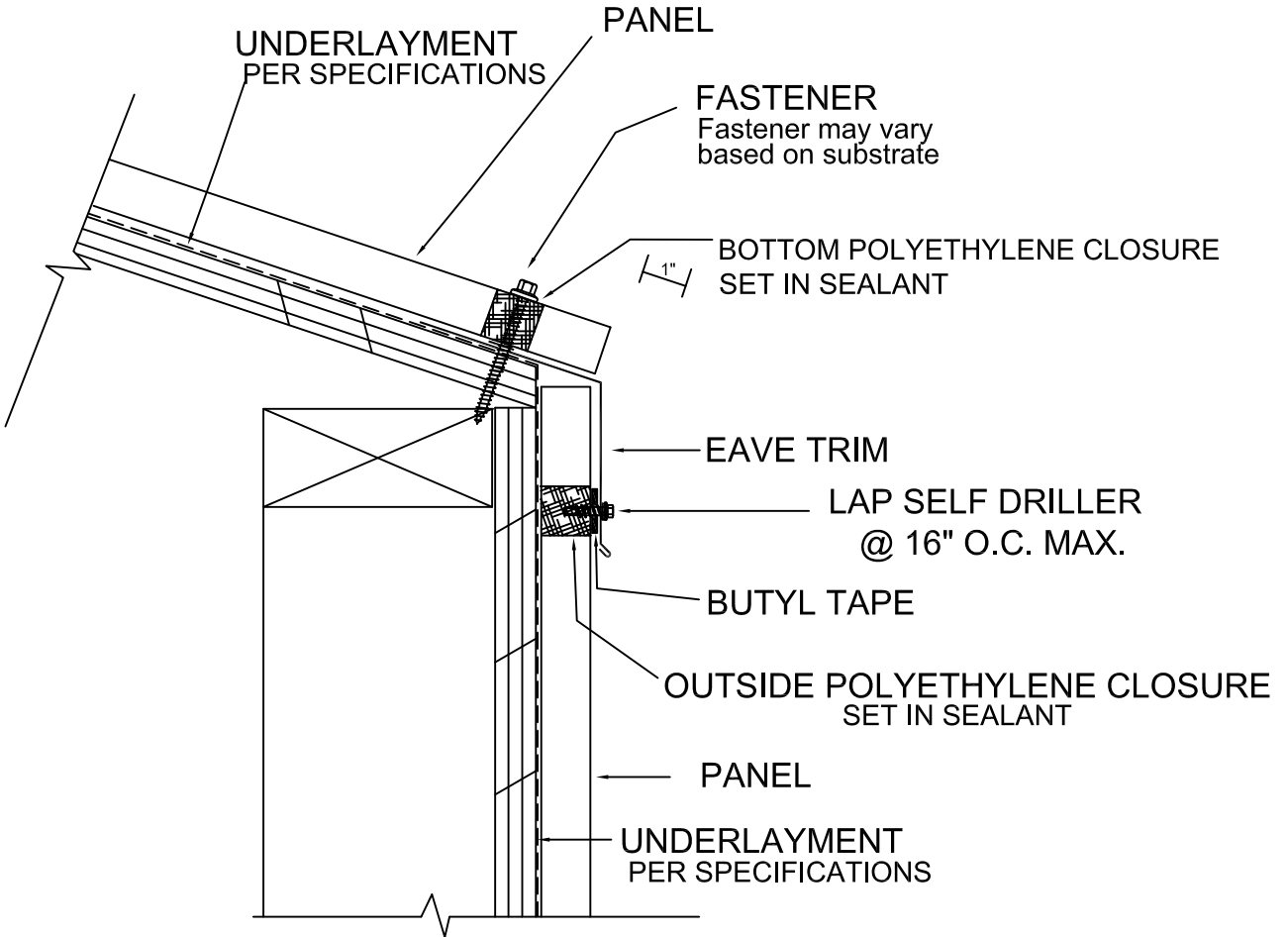

DRAWING: EAVE

All Flashing and Trim available through CBM	Note:
SUBJECT TO CHANGE WITHOUT NOTICE	

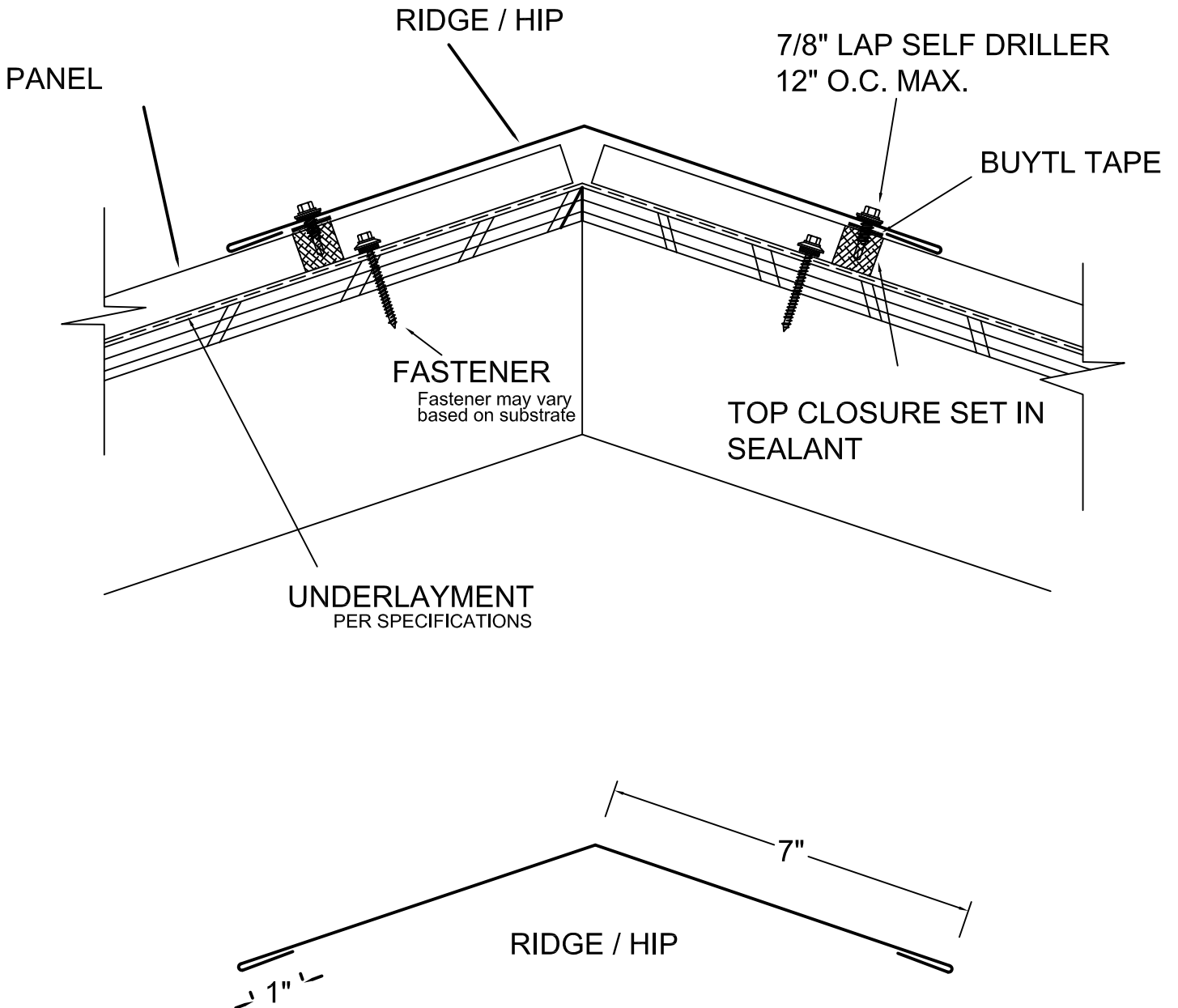

DRAWING: RIDGE

All Flashing and Trim available through CBM	Note:
SUBJECT TO CHANGE WITHOUT NOTICE	

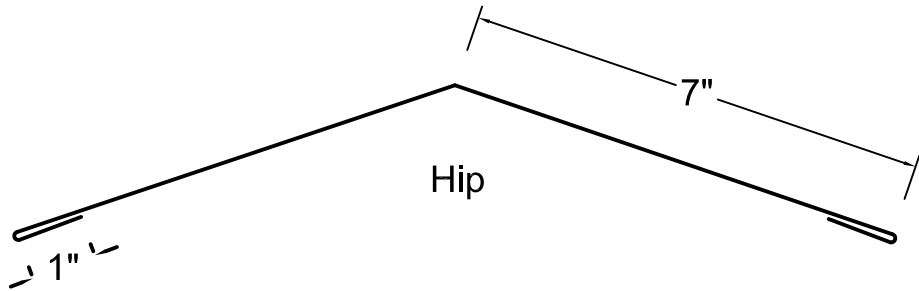
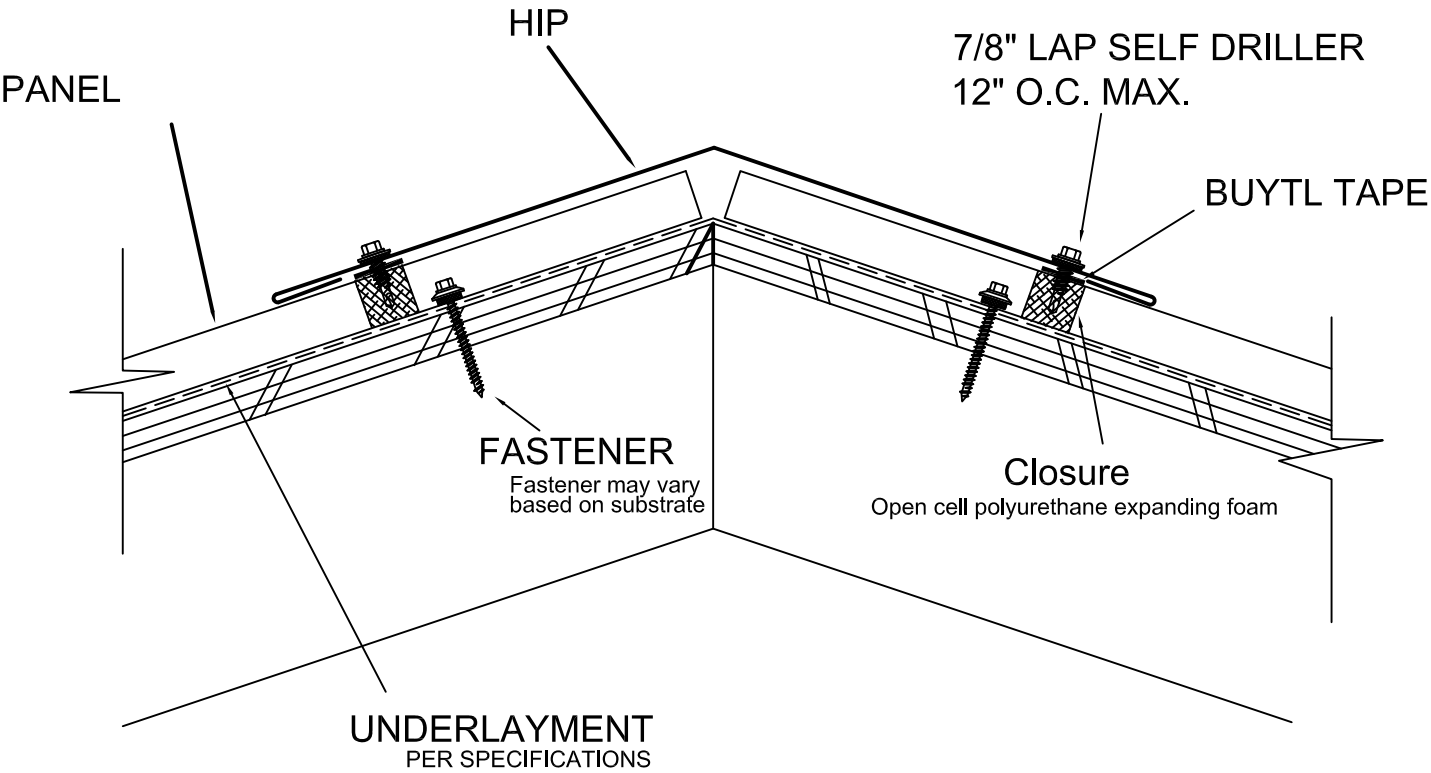

DRAWING: HIP

All Flashing and Trim available through CBM	Note:
SUBJECT TO CHANGE WITHOUT NOTICE	

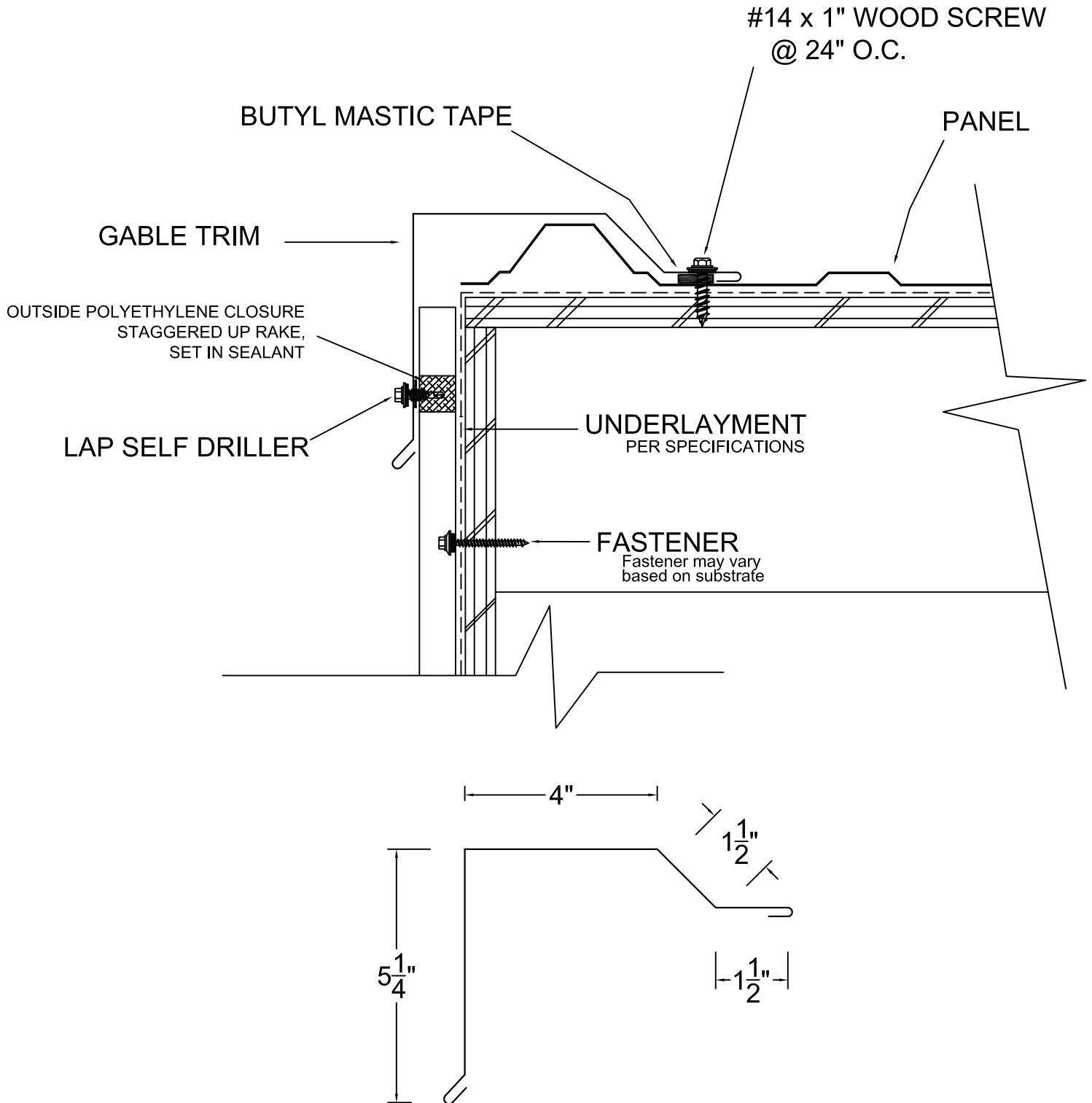

DRAWING: GABLE

All Flashing and Trim available through CBM	Note:
SUBJECT TO CHANGE WITHOUT NOTICE	

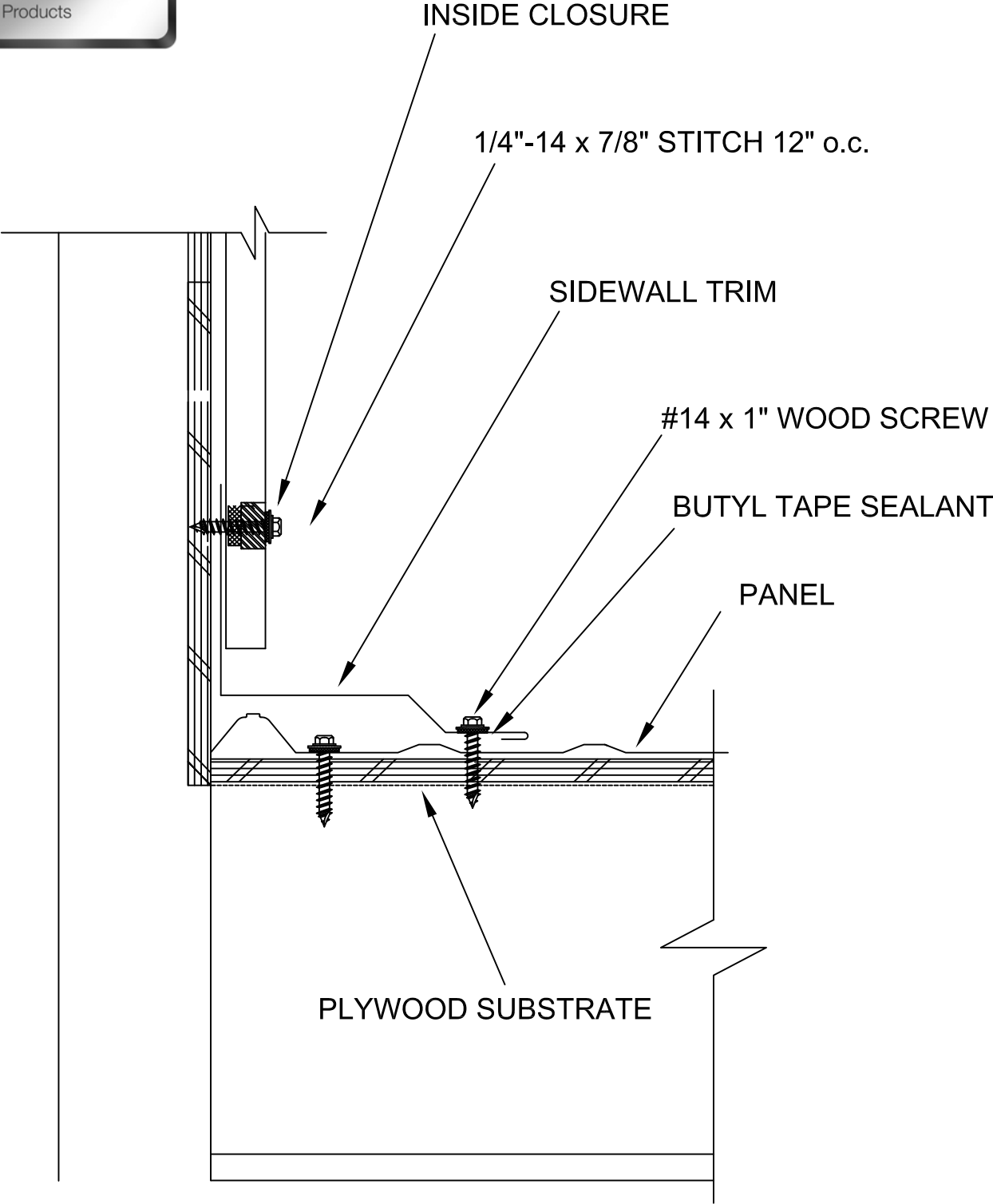

DRAWING: SIDEWALL

All Flashing and Trim available through CBM	Note:
SUBJECT TO CHANGE WITHOUT NOTICE	

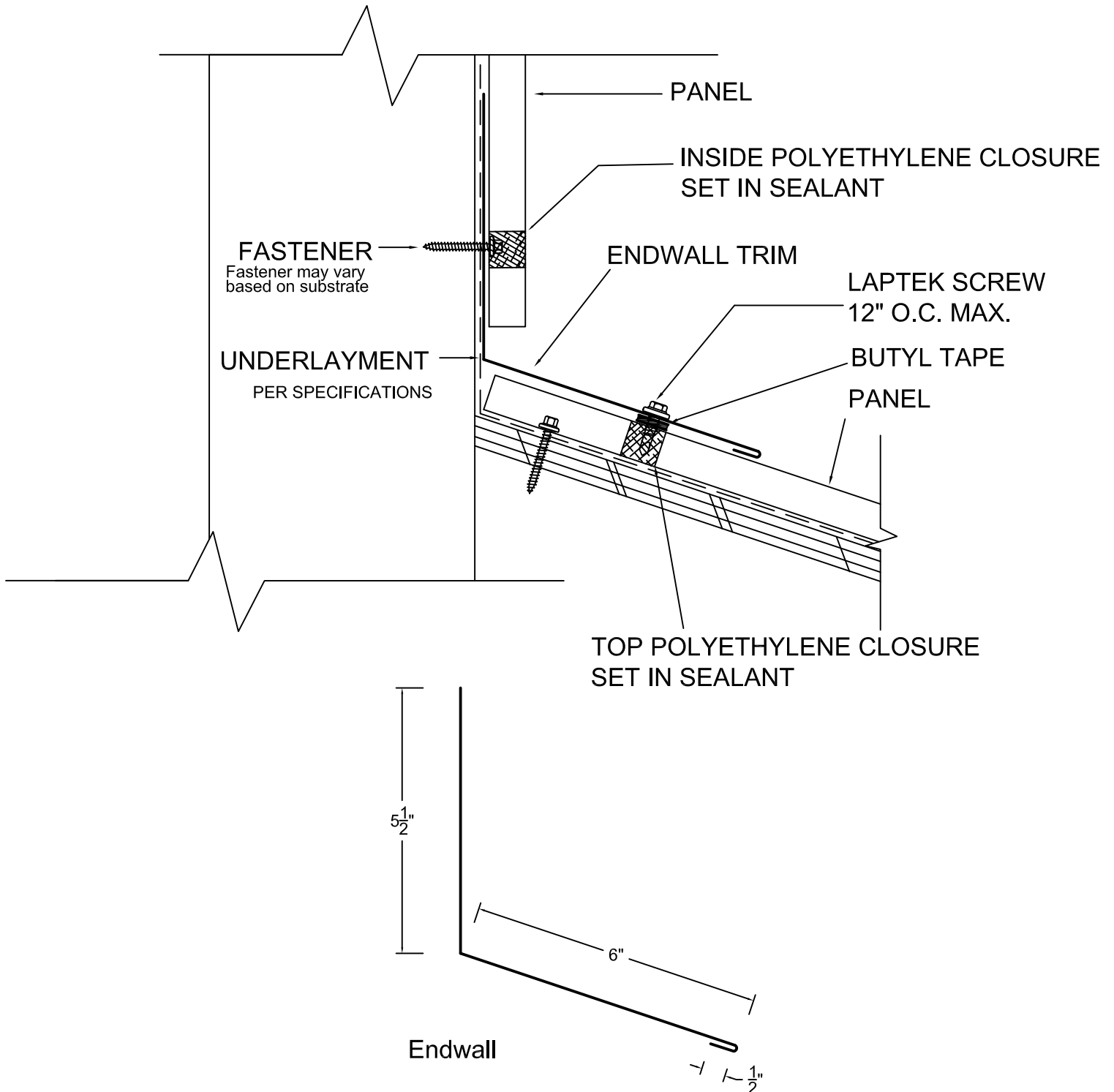

DRAWING: HEADWALL

All Flashing and Trim available through CBM	Note:
SUBJECT TO CHANGE WITHOUT NOTICE	

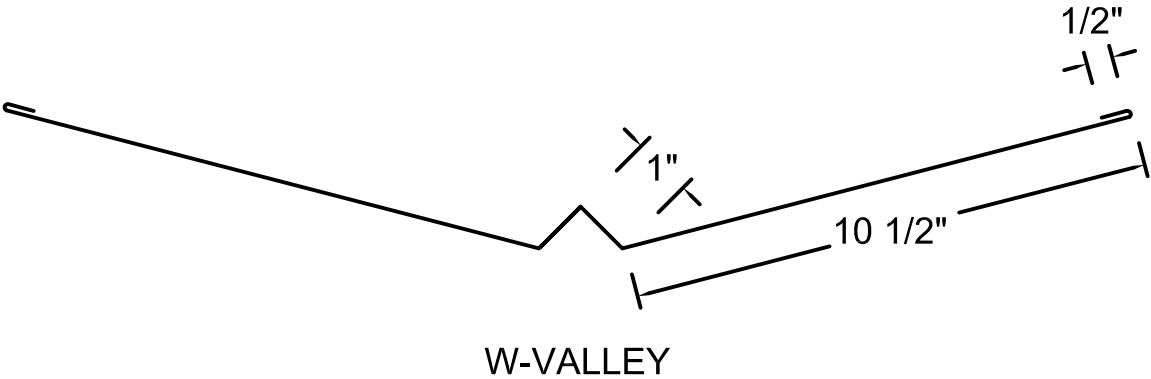
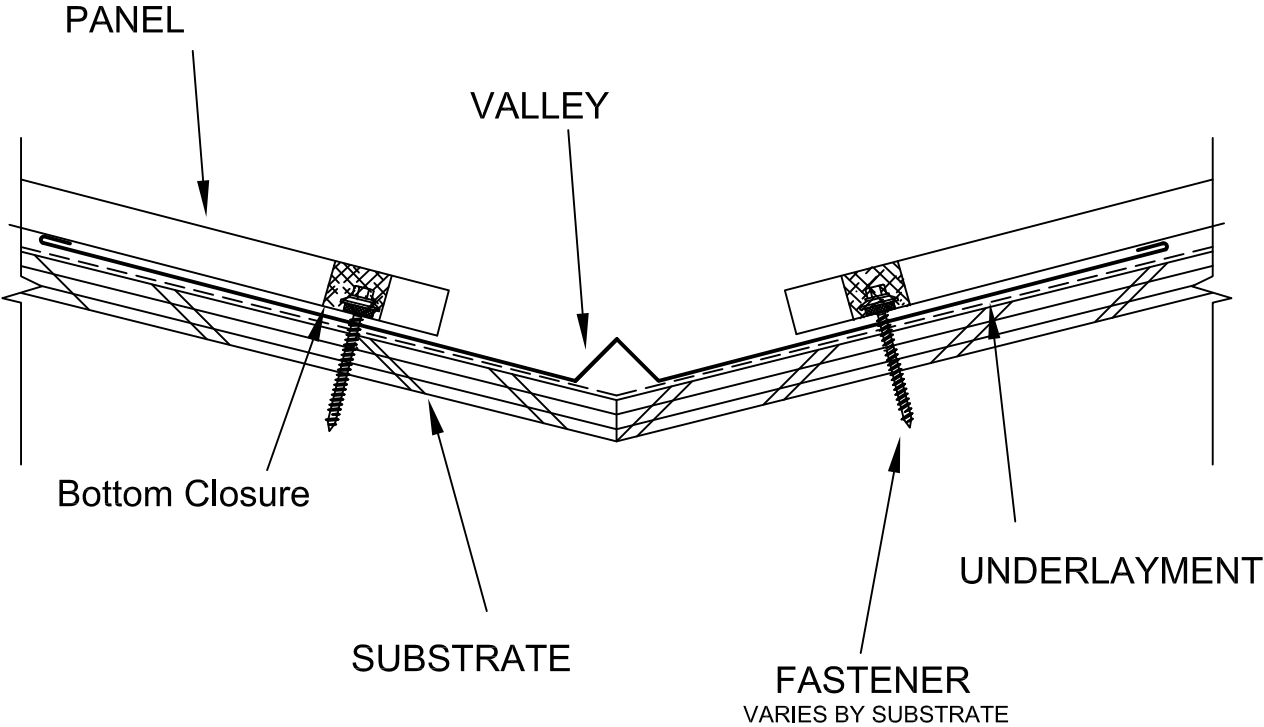

DRAWING: VALLEY

All Flashing and Trim available through CBM	Note: VALLEY DIMENSIONS MAY BE ADJUSTED TO ACCOUNT FOR SLOPE, SNOW, ICE AND HEAVY RAIN CONDITIONS.
SUBJECT TO CHANGE WITHOUT NOTICE	

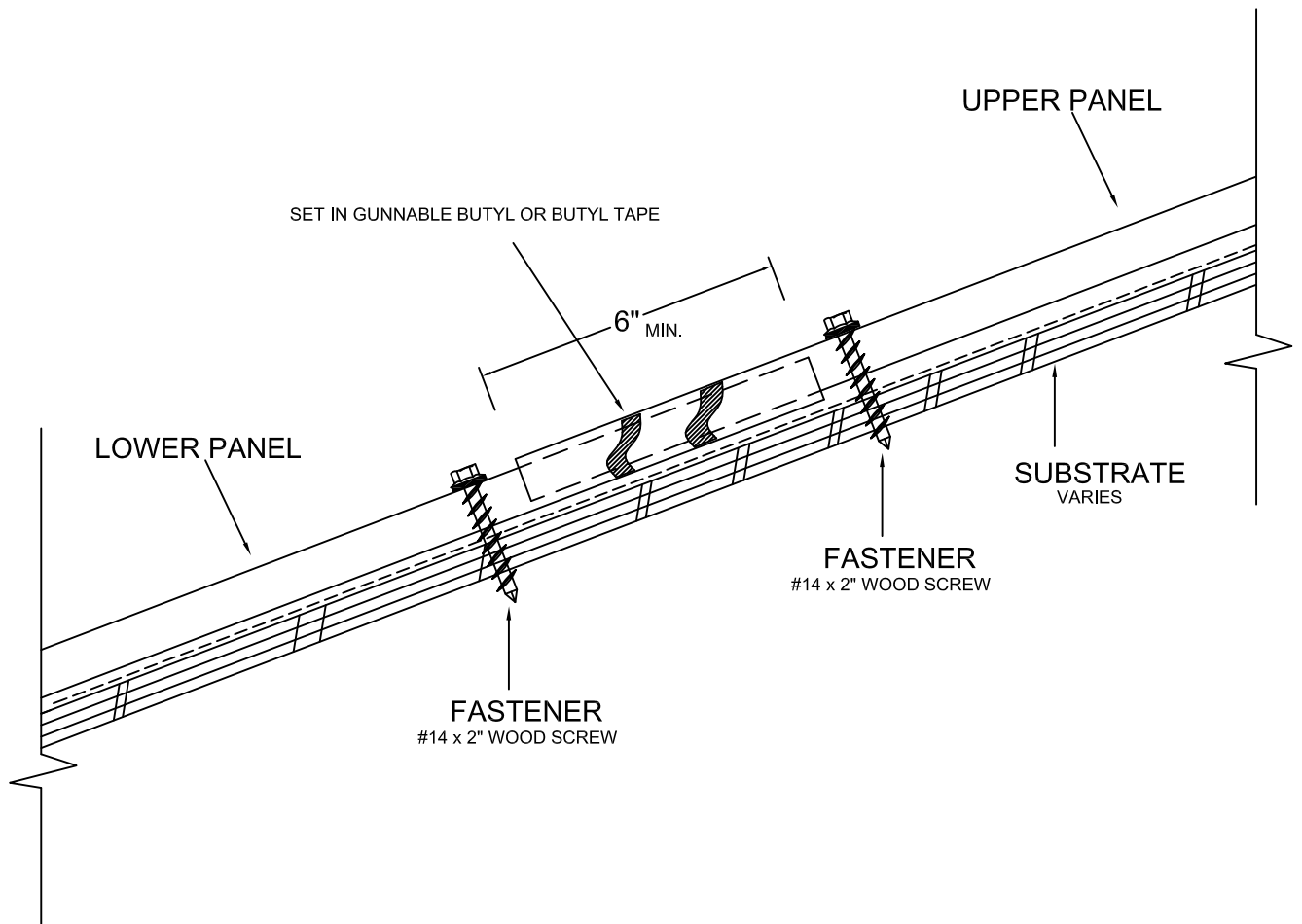

DRAWING: PANEL LAP

All Flashing and Trim available through CBM	Note:
SUBJECT TO CHANGE WITHOUT NOTICE	

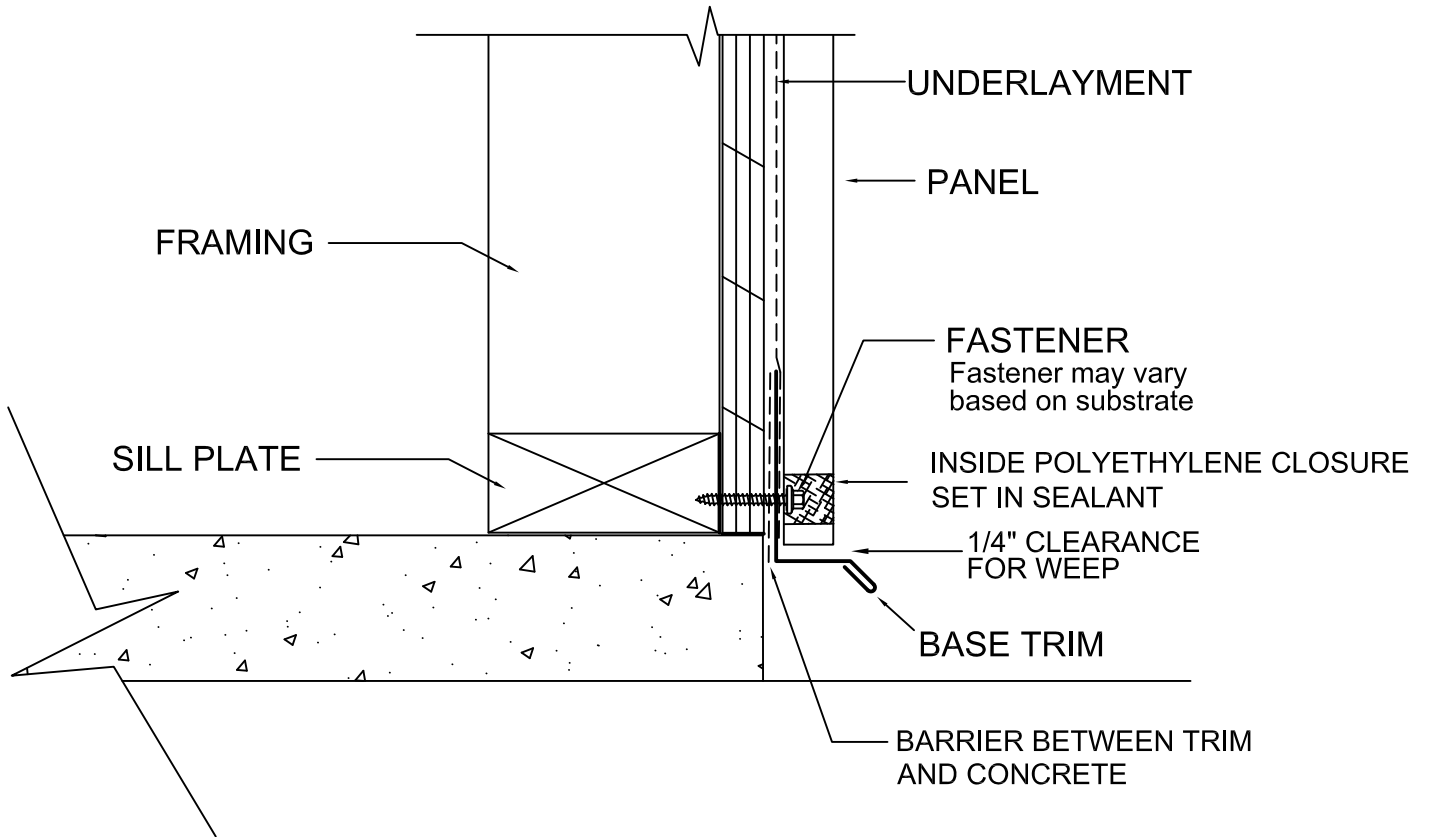

Base Trim

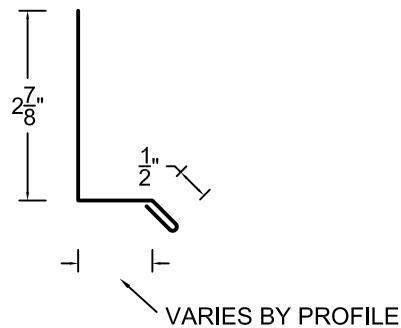

DRAWING: WALL BASE

All Flashing and Trim available through CBM

SUBJECT TO CHANGE WITHOUT NOTICE

Note: Panel Vertical

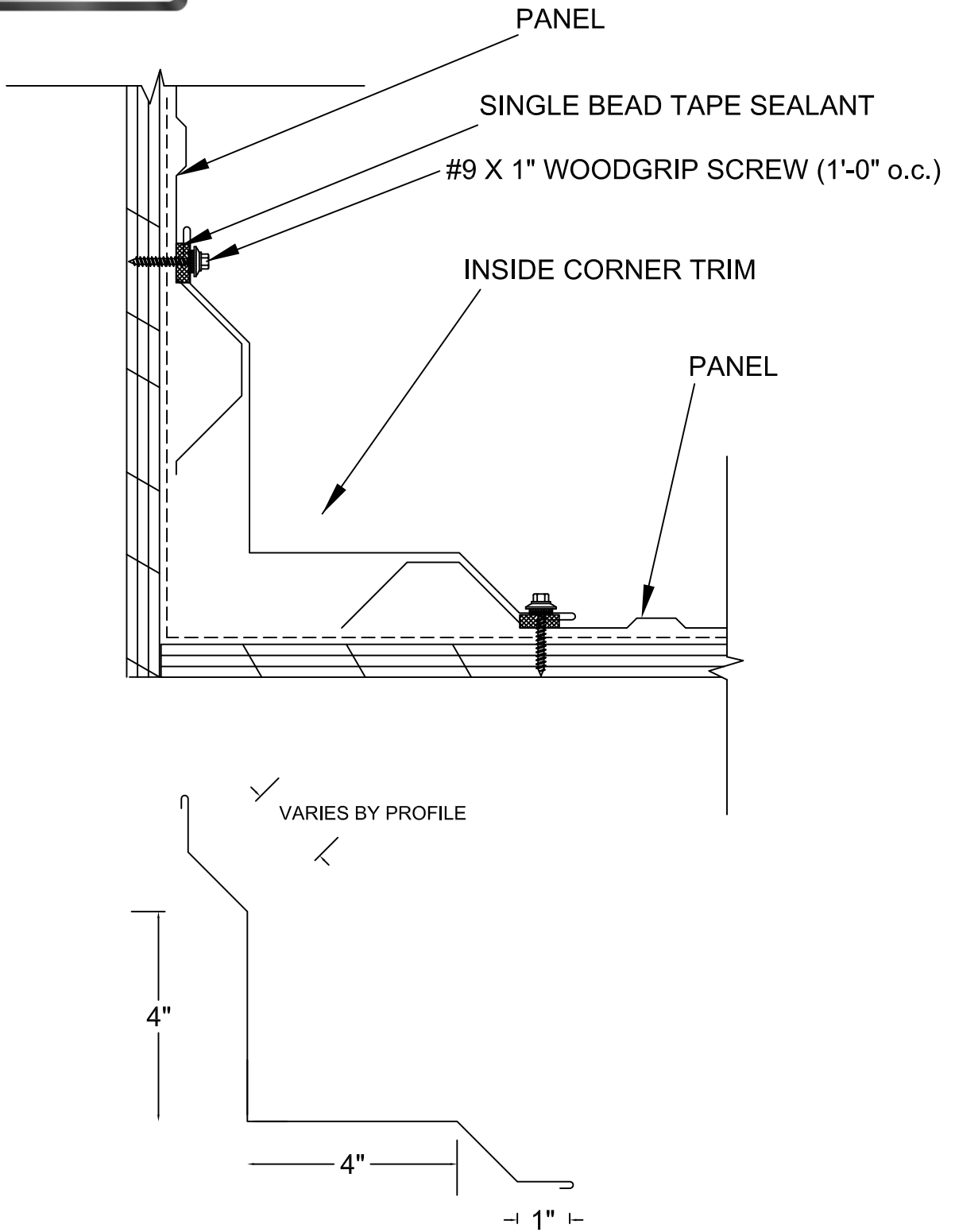

DRAWING: INSIDE CORNER

All Flashing and Trim available through CBM	Note:
SUBJECT TO CHANGE WITHOUT NOTICE	

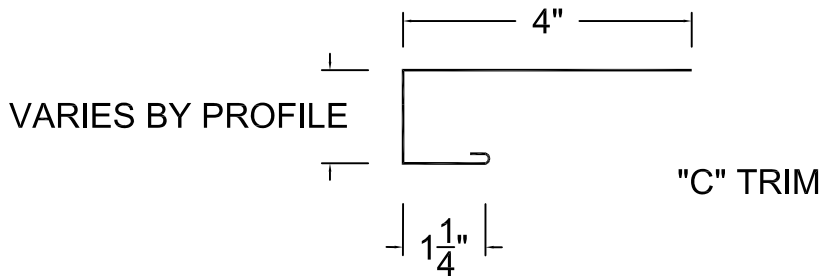
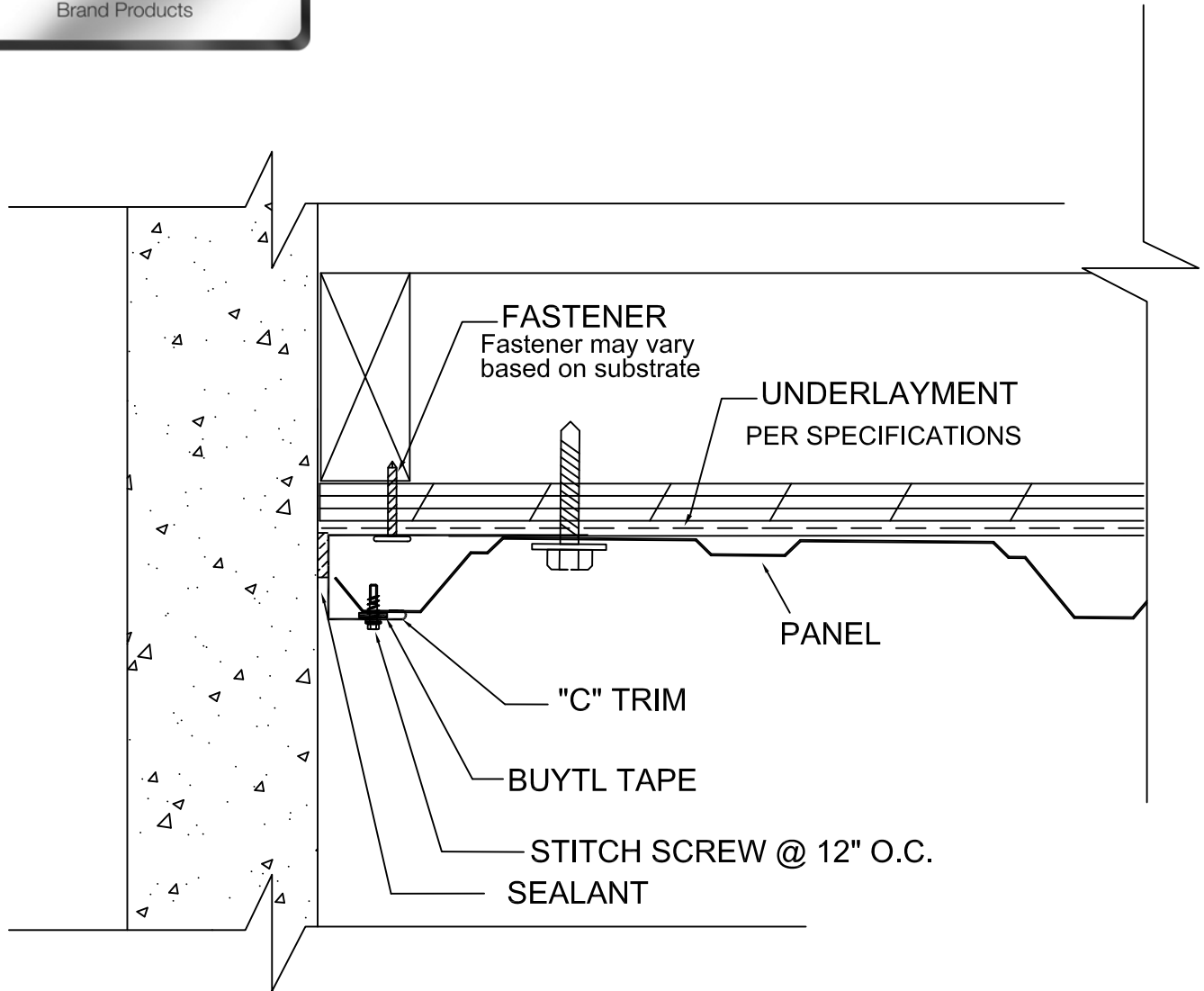

DRAWING: INSIDE CORNER TERMINATION

All Flashing and Trim available through CBM	Note: Panels Vertical
SUBJECT TO CHANGE WITHOUT NOTICE	

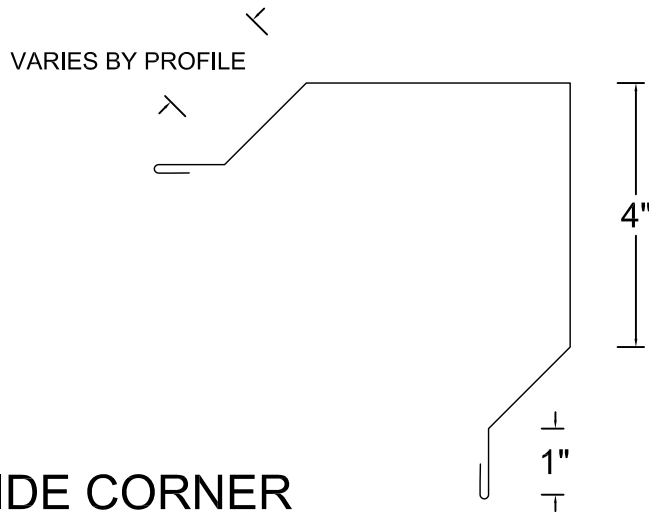
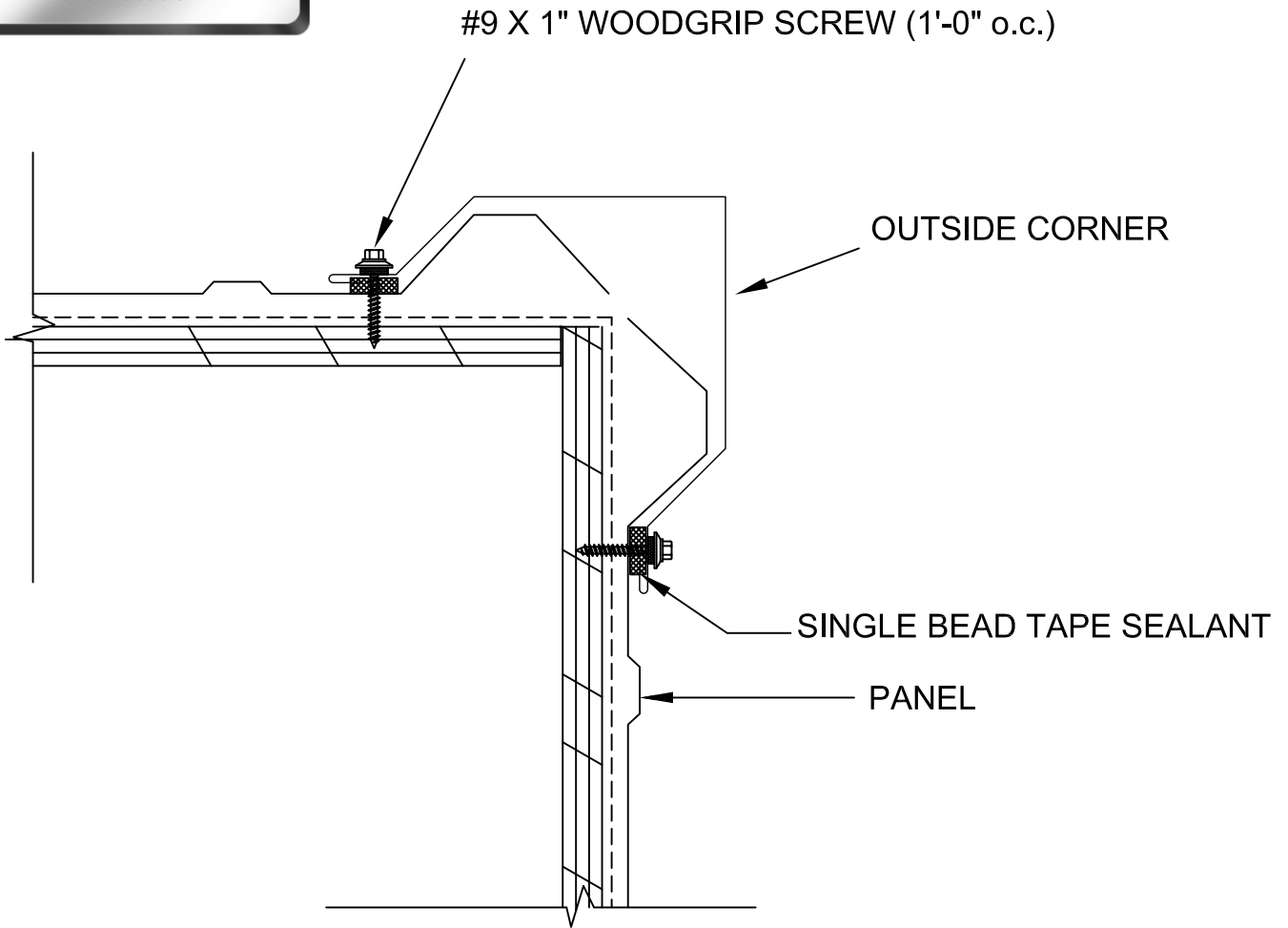

DRAWING: OUTSIDE CORNER

All Flashing and Trim available through CBM	Note:
SUBJECT TO CHANGE WITHOUT NOTICE	

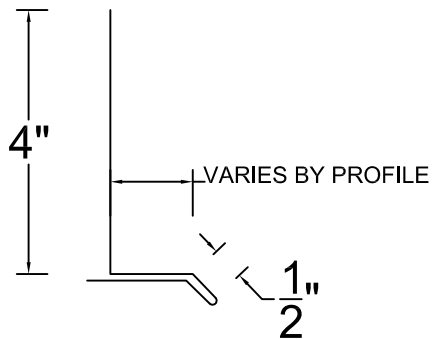
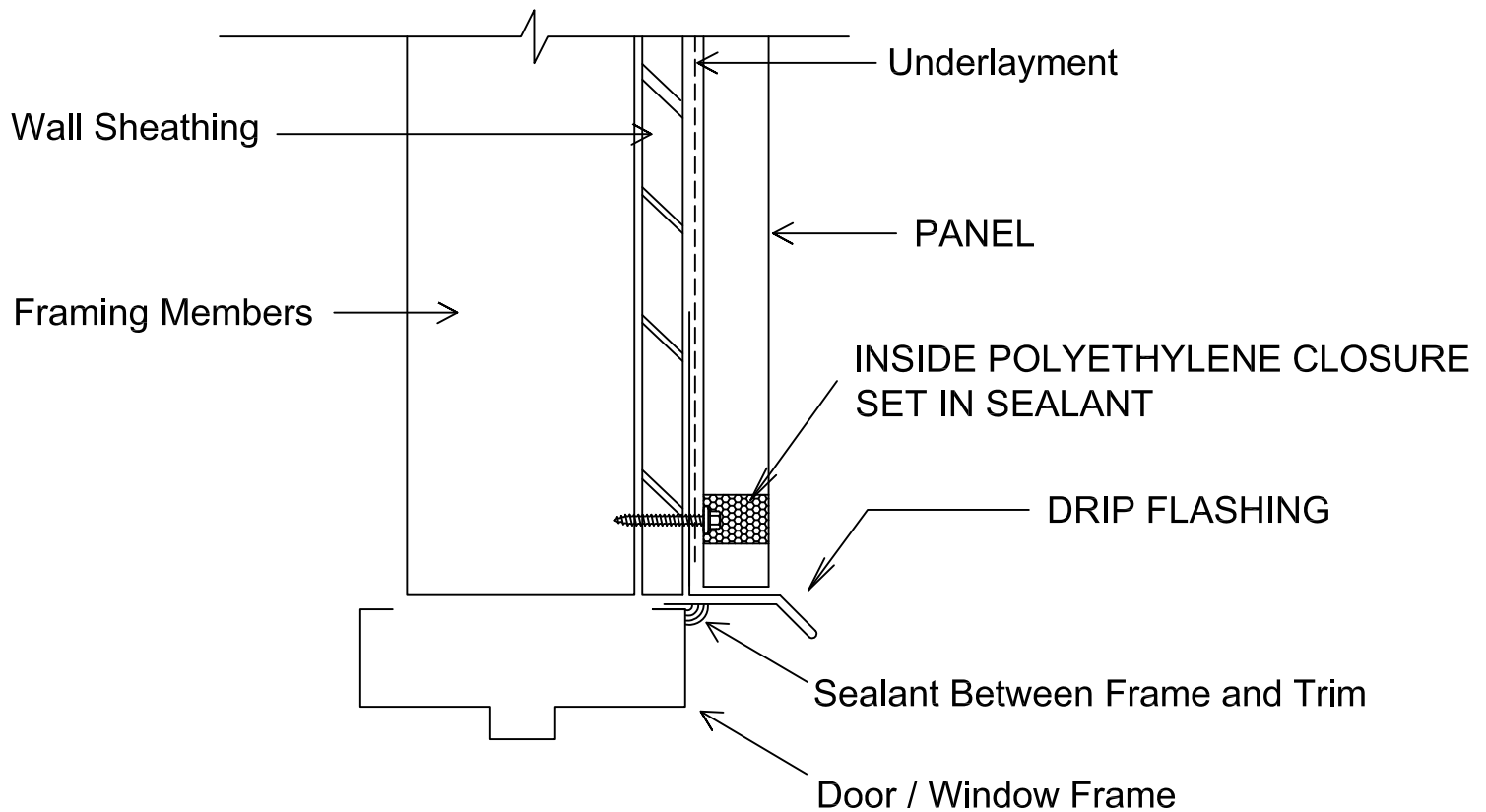

DRAWING: 7/8" DOOR / WINDOW HEAD FLASHING

All Flashing and Trim available through CBM	Note:
SUBJECT TO CHANGE WITHOUT NOTICE	

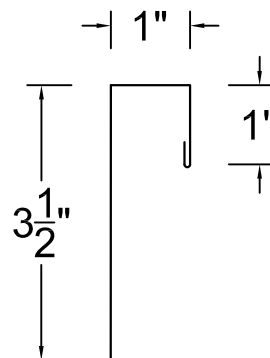
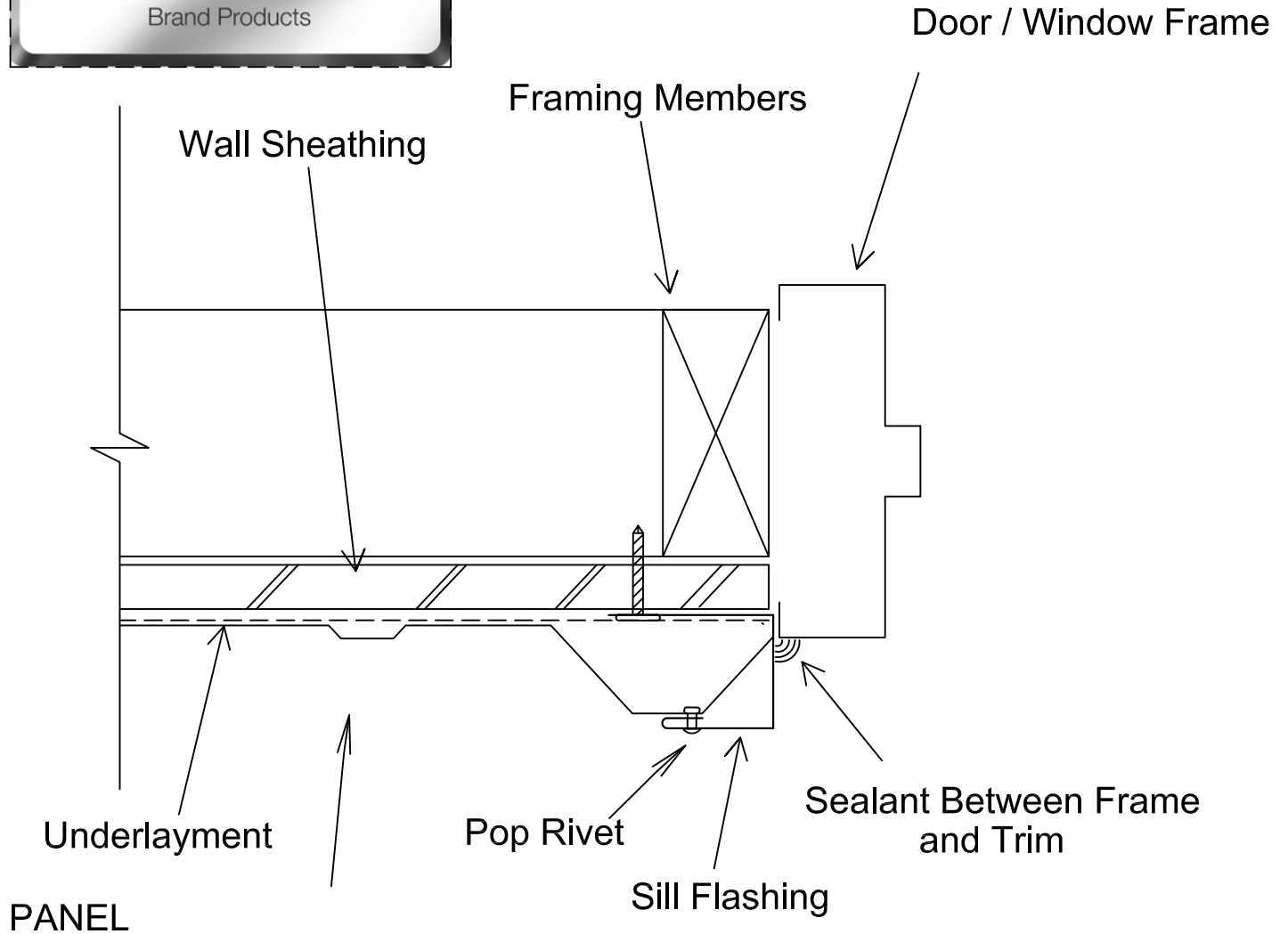

7/8 " CORRUGATED "C" TRIM

DRAWING: DOOR / WINDOW JAMB

All Flashing and Trim available through CBM	Note:
SUBJECT TO CHANGE WITHOUT NOTICE	

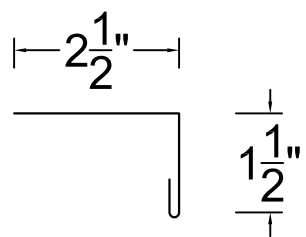
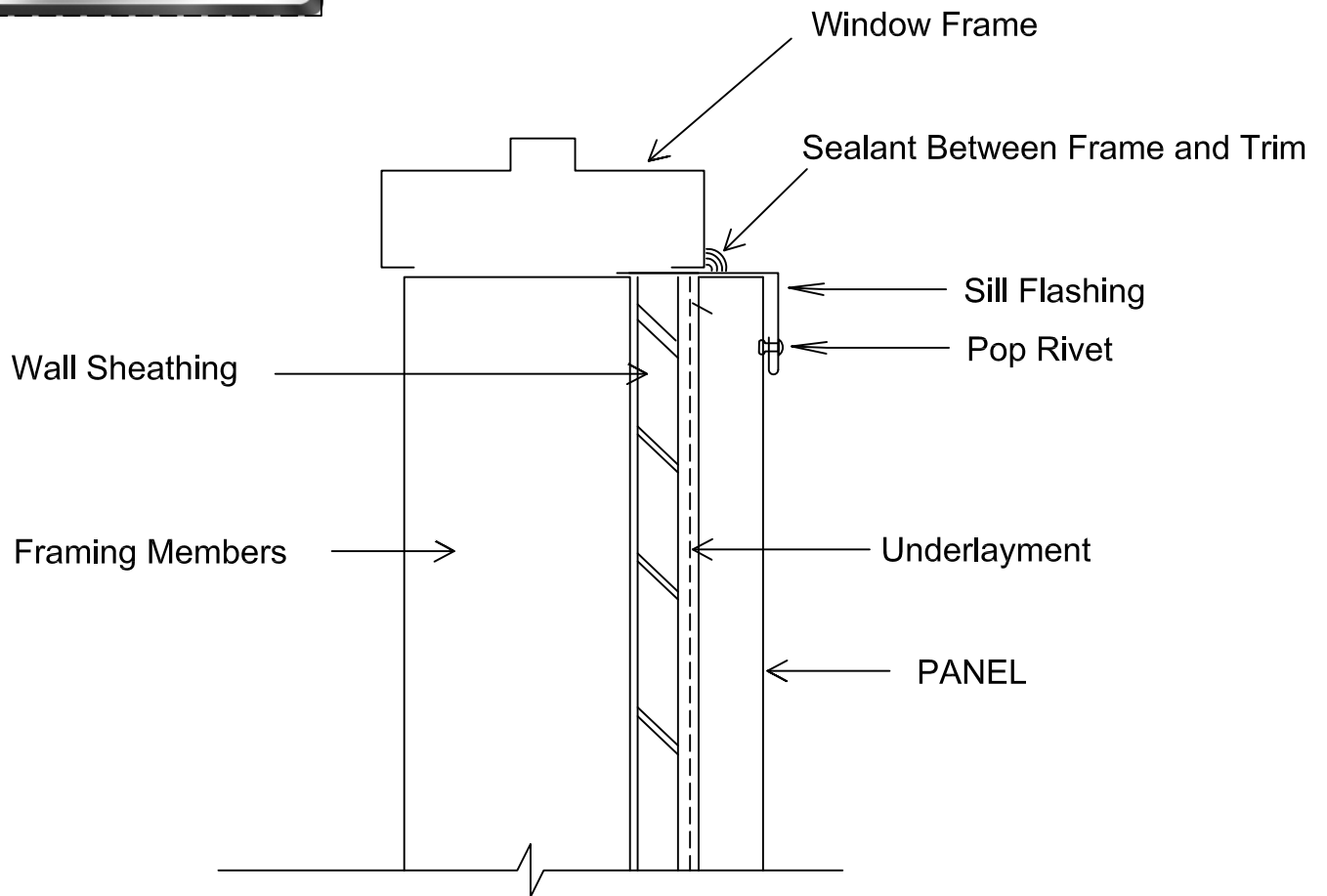

Sill Flashing

DRAWING: WINDOW SILL FLASHING

All Flashing and Trim available through CBM	Note:
SUBJECT TO CHANGE WITHOUT NOTICE	

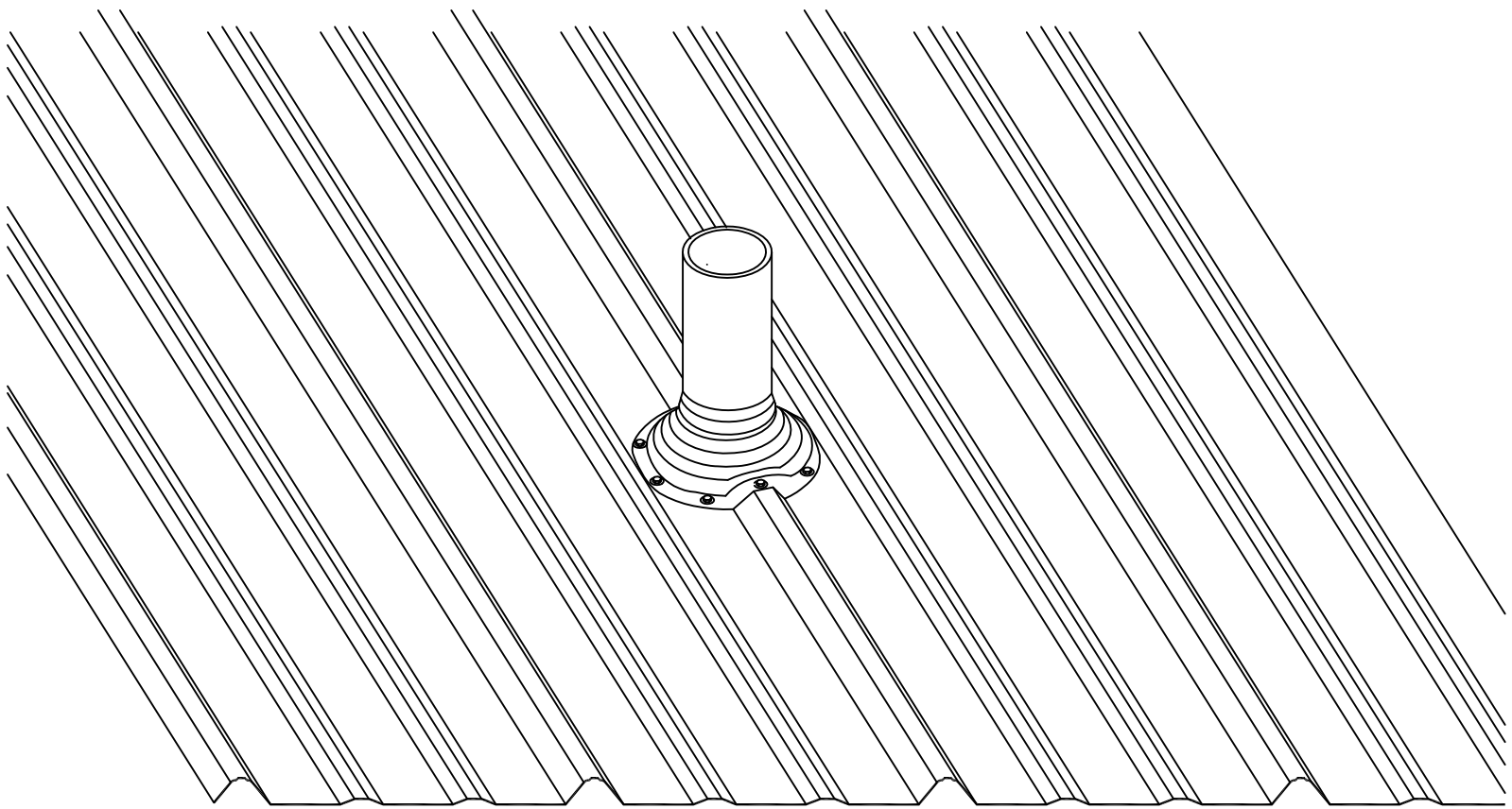

Rubber Boot Flashing
Set in Butyl Tape Sealant

DRAWING: PIPE with RUBBER BOOT

All Flashing and Trim available through CBM	Note:
SUBJECT TO CHANGE WITHOUT NOTICE	